

LIFE-HAMMER®
WE PROTECT LIFE

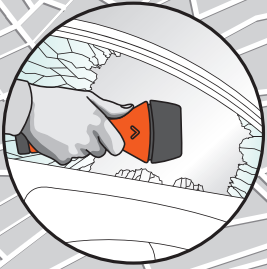

**SAFETY HAMMER
EVOLUTION**



Developed by the highest technical standards. When the head of the hammer is pressed against the side or rear window, the ceramic tip automatically shatters the tempered glass. Easy and safe to use by adults and children. Does not work on laminated glass.

SAFETY HAMMER EVOLUTION

Automatic safety hammer



- Safely and easily shatter the side or rear window. Does not work on laminated glass.



<https://vimeo.com/user12940431/review/76860772/333b7e98bd>

- Non-slip grip. Easy to use by adults and children.

Advanced seatbelt cutter.



- Ultrahard ceramic hammerhead.



- TÜV certified.



- Available in orange and graphite.

Graphite not available in retail packaging.



- Winner of various international design competitions.



Easy installation

The Quick Click System is standard in the retail packaging. The other systems shown are available in bulk.

Screws are required when using only the PRO adapter.

Clamp fastener for car door QUICK CLICK SYSTEM



Clamp fastener for middle console EASY FIX SYSTEM



Fastening with screws PRO ADAPTER



QUICK CLICK SYSTEM CAR DOOR

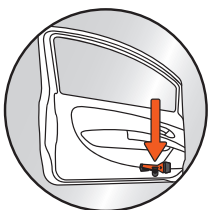

With this system you can mount the safety hammer on the inside of a car door. Rotate the small click-adapter for the optimal positioning. It is possible to use the QUICK CLICK SYSTEM in combination with the Pro adapter. Screws are not required to attach this system to the car.

EASY FIX SYSTEM CENTER CONSOLE

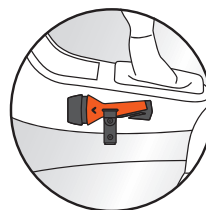

With this system you can mount the safety hammer on either side of the center console. Rotate the small click-adapter for the optimal positioning. It is possible to use the EASY FIX SYSTEM in combination with the PRO adapter. Screws are not required to attach this system to the car.

www.lifehammerproducts.com